

**Lake Sinissippi Improvement District
PO Box 89
Hustisford, WI 53034**

June 2006

Water Quality Tests For Home Drinking Water

Dear Lake District Property Owners:

Residents of the Upper Rock River Basin withdraw groundwater for drinking and domestic use from gravel and bedrock aquifers located below the ground surface. Generally, the quality of our groundwater source is good. However, contamination of groundwater can occur, often from human activities that cause bacterial and chemical pollutants to reach the underground aquifers.

Wells that provide public drinking water are regularly tested for bacteria and other contaminants by state and local authorities. Testing of private wells is generally the responsibility of homeowners.

Private well owners within the Lake District have the opportunity to have their well water tested as part of a program sponsored by Lake Sinissippi Improvement District, Dodge County UW-Extension and UW-Stevens Point Water and Environmental Analysis Laboratory.

Water samples from your private well can be tested for coliform bacteria, nitrates and other chemical parameters, metals and pesticides. Details regarding the testing service are given in the enclosed brochure. The cost of the analyses will be paid by the homeowner. Sample bottles are available at UW-Extension office in Juneau and at the Lake District office in Hustisford.

The date for water sample collection and testing is **Sunday, June 25th**. Samples need to be delivered to the Lake District office on Sunday between 9:00 AM and 1:00 PM. The test results will be available in July and presented at an educational program for participants.

Sincerely,

Board of Commissioners
Lake Sinissippi Improvement District

Enclosure

Sinissippi Lake

Dodge County

June 2006

- Town Boundary
- Streams
- Lakes/Reservoirs
- Wetlands
- State/US Highways
- Other Roads
- Municipalities



0 0.5 1 Miles



Groundwater Center
Center for
Watershed Science
and Education

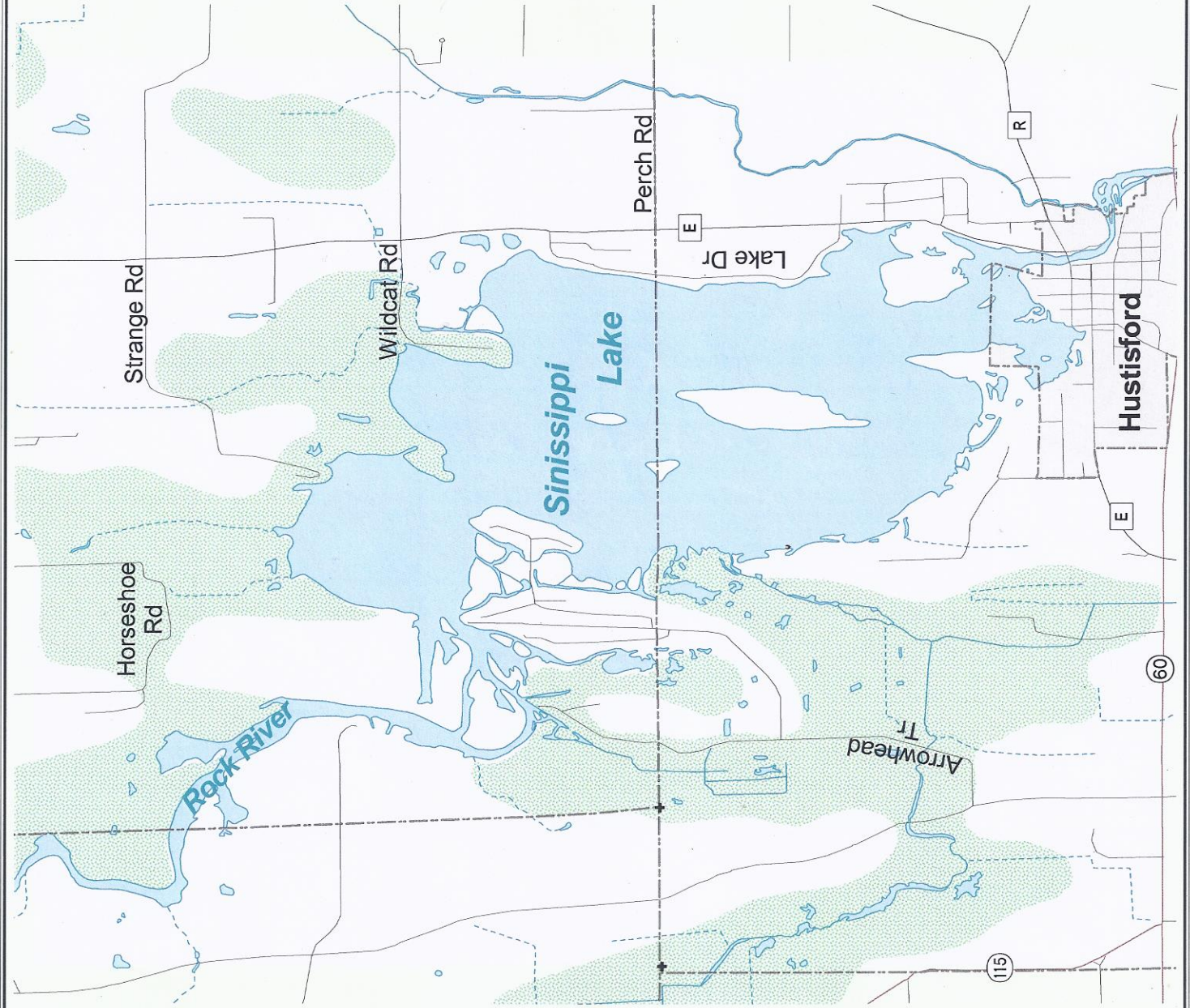

Sinissippi Lake

Dodge County
June 2006

SAMPLE DISTRIBUTION

NUMBER OF SAMPLES
per 1/4 1/4 SECTION:

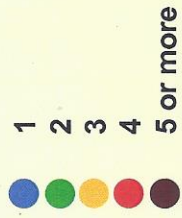

Groundwater Center
Center for
Watershed Science
and Education

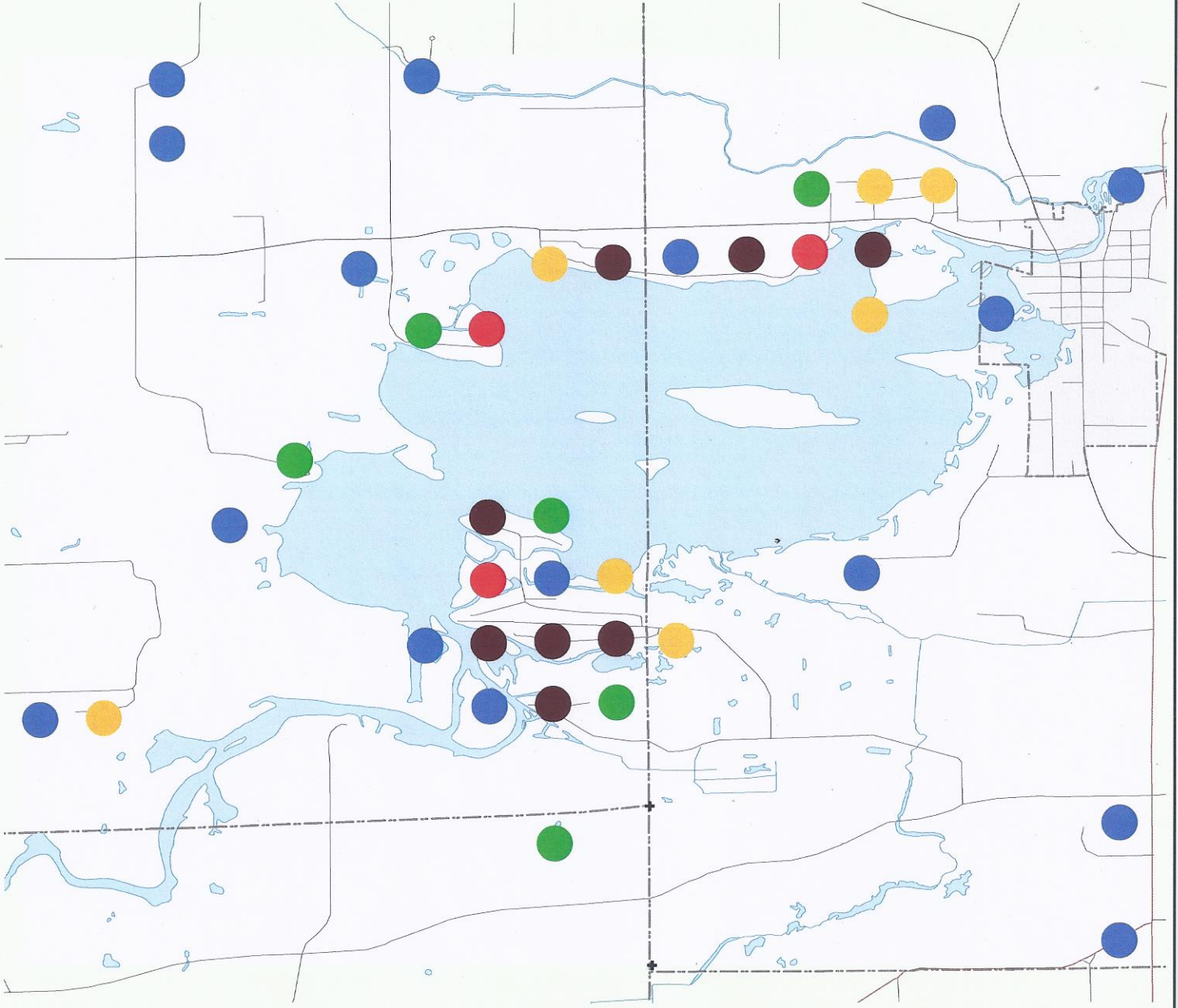

Sinissippi Lake

Dodge County
June 2006

NITRATE-NITRITE (ppm N)

NONE DETECTED	77	73 %
[0.1 - 2.0)	25	24 %
[2 - 5)	2	2 %
[5 - 10)	1	1 %
[10 - 20)	0	0 %
[20 ...	0	0 %

Mapped value is average for 1/4 1/4 section.



0 0.5 1 Miles

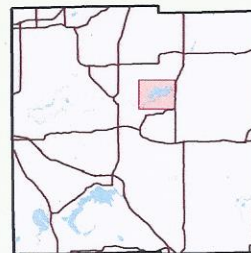

Groundwater Center
Center for
Watershed Science
and Education

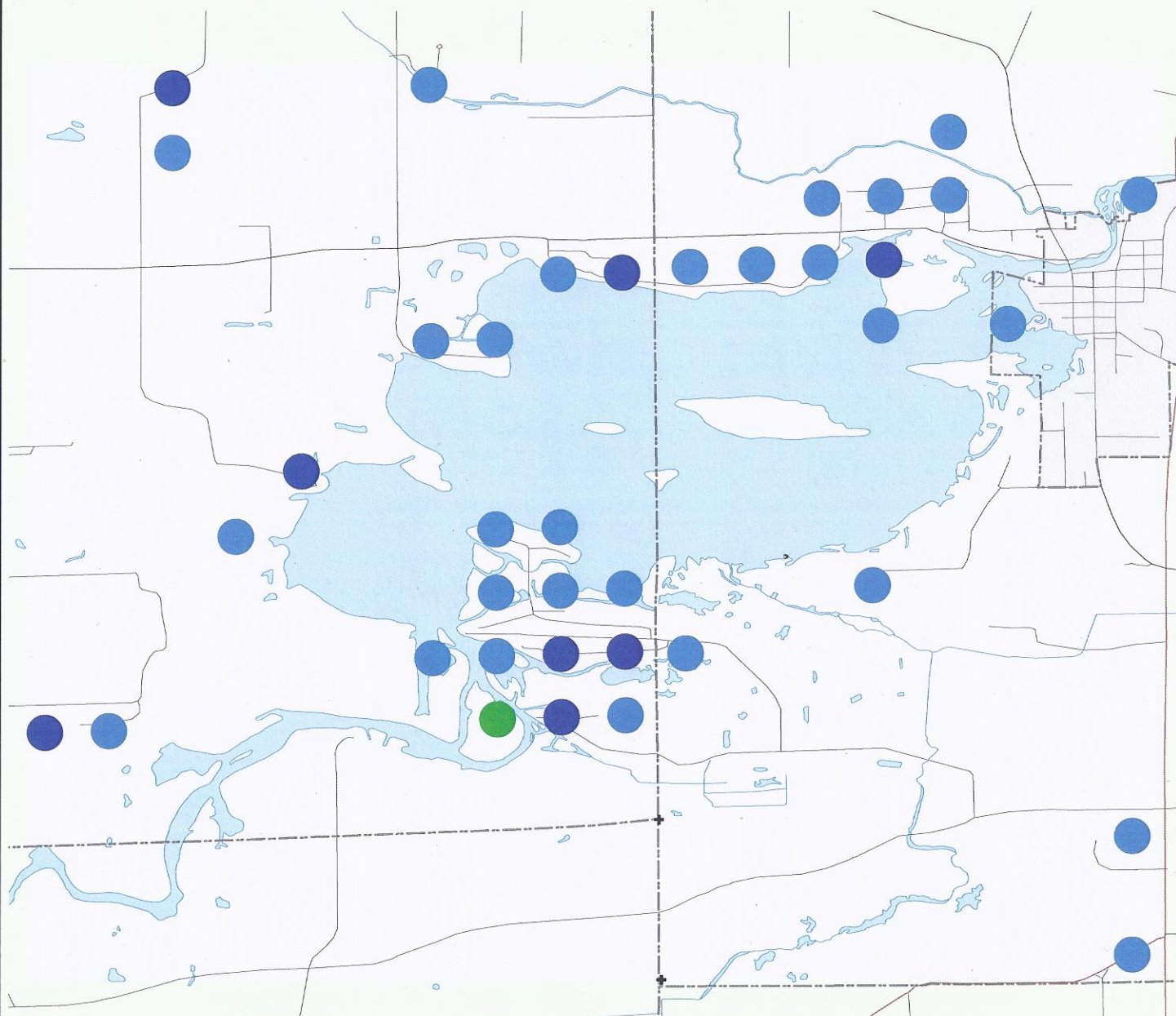

Sinissippi Lake

Dodge County
June 2006

*** BACTERIA POSITIVE**
(Any sample in 1/4 1/4 section.)



0 0.5 1 Miles

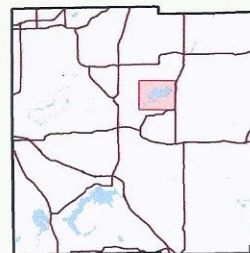

Groundwater Center
Center for
Watershed Science
and Education

